

Property Exhibit

of
A Proposed 1 Lot Certified Survey Map,

on
A Portion of Tax Parcel BD 3400009,

located in the Southwest 1/4 of the Northwest 1/4 and the Northwest 1/4 of the Southwest 1/4 of Section 34, Town 2 North, Range 15 East, Town of Darien, Walworth County, Wisconsin.

Prepared for: **Shee N Eye, LLC**
N2690 Wise Road
Darien, Wisconsin. 53114

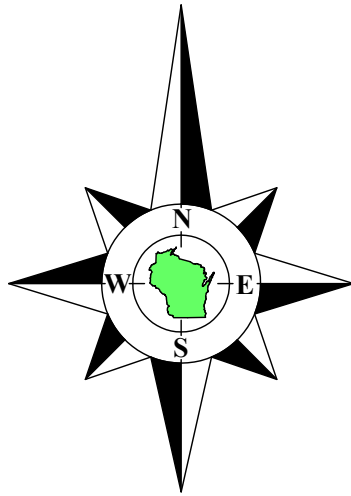

Bearings referenced to the West line of the Northwest 1/4 of Section 34-2-15, recorded as N1°02'13"W in the Wisconsin State Plane Coordinate System, South Zone, (NAD-27).

Coordinates are referenced to the Wisconsin State Plane Coordinate System, South Zone, (NAD-27).

**Tax Parcel
BD 3400009**

Approx. 57.135 Acres

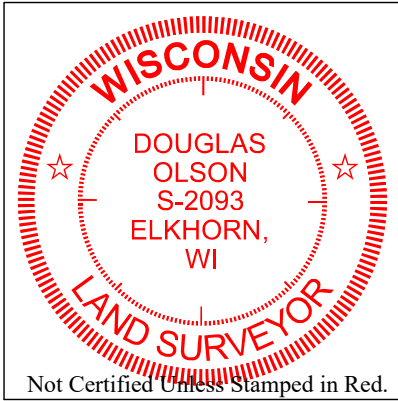

Notes:

- 1) This Plat of Survey is not certified unless signed and sealed in red ink.
- 2) This survey is subject to Wisconsin lien laws. This Plat of Survey is the notice of intent to file lien. Lien waiver required.
- 3) The Survey Date shown on this Plat of Survey is the completion date of the field work.

Copyright © 2023 by Olson Land Surveying, LLC.

All rights reserved. No part of this survey plat may be reproduced or transmitted in any form by any means - graphic, electronic, or mechanical, including photocopying, tracing, or information storage and retrieval systems - without permission in writing from Douglas G. Olson, Olson Land Surveying, LLC.

I hereby certify that I have surveyed the above described property in compliance with Chapter A-E 7 of the Wisconsin Administrative Code and that the map hereon is correct to the best of my professional knowledge and belief and shows the size and location of the property, its exterior boundaries, the location and dimensions of all visible structures thereon, boundary fences, apparent easements and roadways and visible encroachments, if any.

This survey is made for the exclusive use of the present owners of the property, and also those who purchase, mortgage or guarantee title thereto, within one year from the date hereof.

Douglas G. Olson
Wisconsin Professional Land Surveyor - 2093

Survey Date: May 11, 2023.
Revisions:



45 South Wisconsin Street | P.O. Box 322
Elkhorn, Wisconsin, 53121
Telephone: (262) 723-3434
Facsimile: (262) 723-8044
Email: doug@olsonsurveying.com
Website: www.olsonsurveying.com



Legend of Symbols & Abbreviations	
Found County Section Corner	N North S South E East W West
Set Iron Pipe 1" dia.	Inches
Recorded Information	Bearings Degrees Minutes Seconds
Utility Pole	Distances Feet Miles
Concrete Cover	
Concrete Surface	
Gravel Surface	

Sheet 1 of 1 Sheets	Drawing Name:
Job Reference Number	2023.021

2023.021